

Location

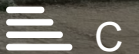

18 Fonton Hall Drive, Sutton-In-Ashfield, NG17 1LD

£450,000



Floor Plan

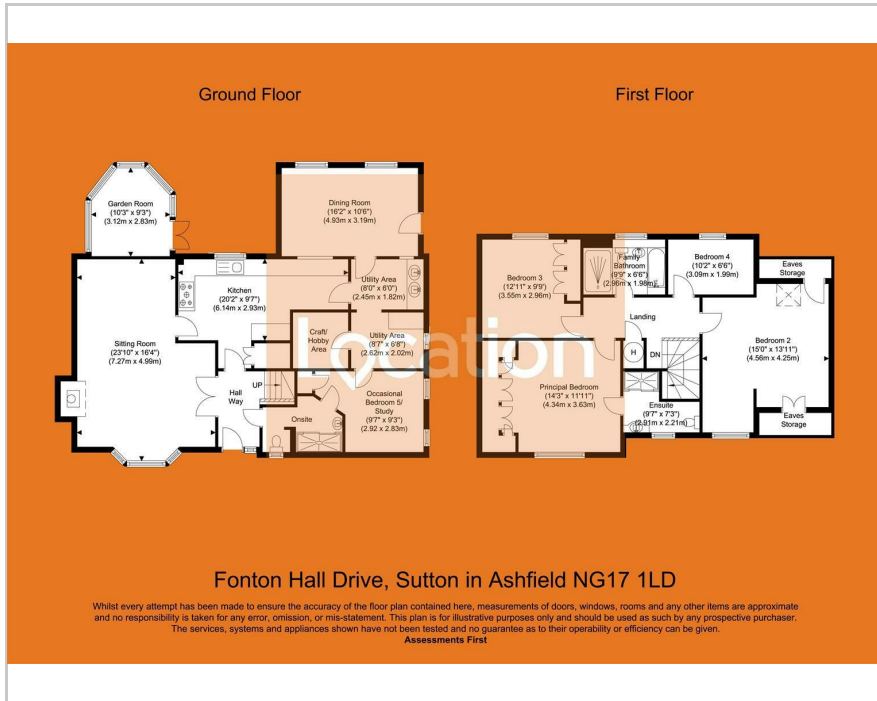

Area Map



Accommodation

- Detached Home
- Four Bedrooms
- Modern Kitchen with Integrated Appliances
- Master Ensuite
- Sun Room
- Sought After Area
- Enclosed Rear Garden



Viewing

Please contact our Mansfield Sales Office on 01623654555 if you wish to arrange a viewing appointment for this property or require further information.

Energy Efficiency Graph

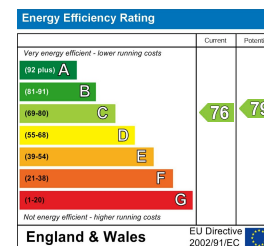

These particulars, whilst believed to be accurate are set out as a general outline only for guidance and do not constitute any part of an offer or contract. Intending purchasers should not rely on them as statements of representation of fact, but must satisfy themselves by inspection or otherwise as to their accuracy. No person in this firm's employment has the authority to make or give any representation or warranty in respect of the property.